

REACHING NEW HEIGHTS



NANO

ULTRA LITE

Lightweight • Easy to Tow • Contemporary Styling

NANO

APEX

By Coachmen

7-1/2' WIDE **ULTRA LITE**

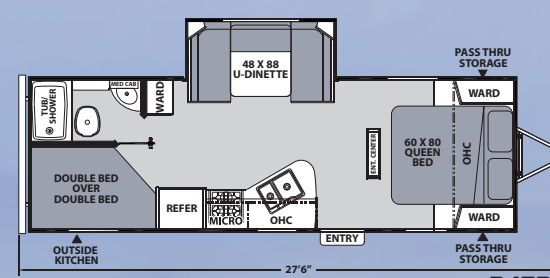
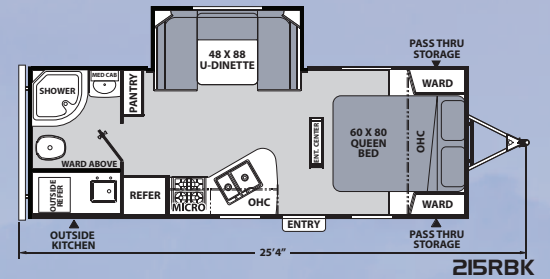
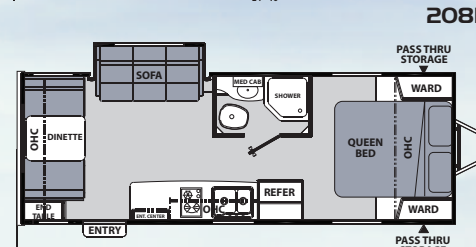
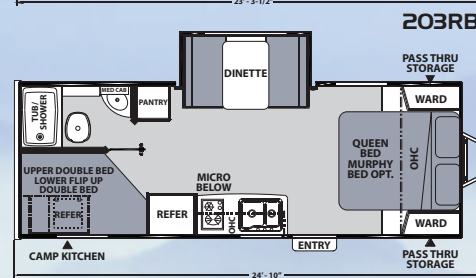
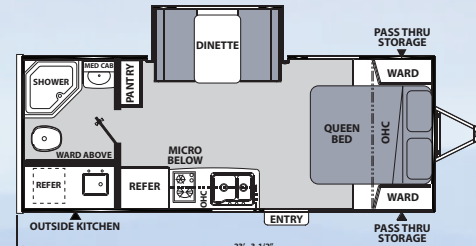
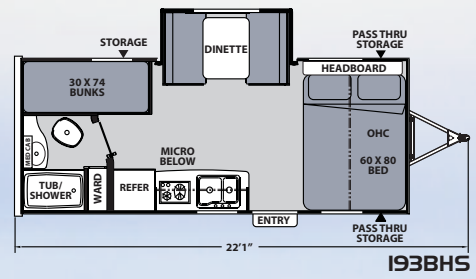
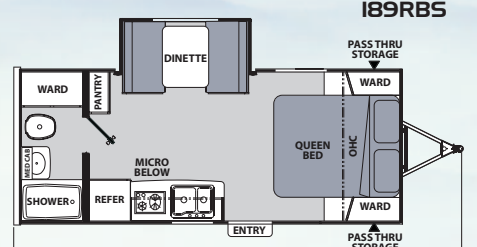
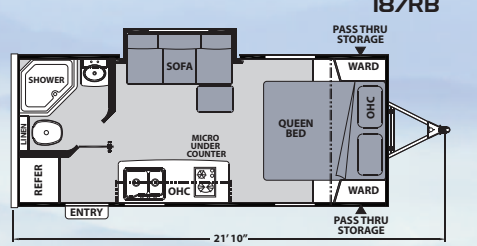
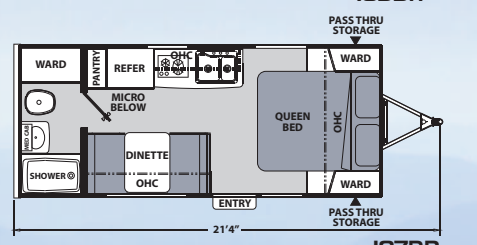
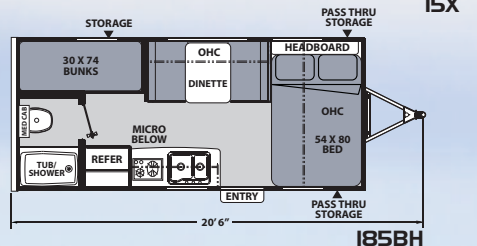
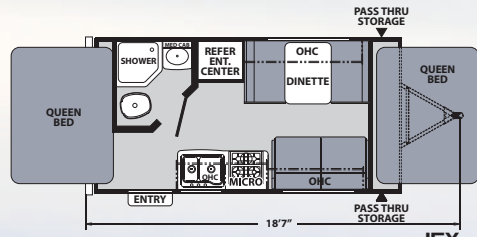

Apex Nano	15X	185BH	187RB	189RBS	191RBS	193BHS	203RBK	208BHS	213RDS
UVW	2,920	2,850	3,034	3,453	3,446	3,495	3,896	3,928	3,806
Hitch Weight	360	350	316	418	406	370	478	516	467
Carrying Capacity	880	950	766	1,247	1,254	1,205	2,104	2,072	2,194
GVWR	3,800	3,800	3,800	4,700	4,700	4,700	6,000	6,000	6,000
Exterior Length (Bumper to Hitch)	18' 7"	20' 6"	21' 4"	21' 10"	21' 10"	22' 1"	23' 4"	24' 11"	25'
Exterior Height (w/A/C)	9' 9"	9' 9"	9' 9"	10'	10'	10'	10'	10'	10'
Fresh Water Capacity (gal.)	30	30	30	30	30	30	30	30	30
Grey Water Capacity (gal.)	30	30	30	30	30	30	30	30	30
Waste Water Capacity (gal.)	30	30	30	30	30	30	30	30	30
Awning Length	12'	12'	12'	12'	12'	12'	15'	14'	15'

Apex 7.5' Wide	215RBK	245BHS
UVW	4,365	4,586
Hitch Weight	446	578
Carrying Capacity	2,135	1,914
GVWR	6,500	6,500
Exterior Length (Bumper to Hitch)	25' 4"	27' 6"
Exterior Height (Includes A/C)	10' 3"	10' 3"
Fresh Water Capacity (gal.)	30	30
Grey Water Capacity (gal.)	30	30
Waste Water Capacity (gal.)	30	30
Awning Length	13'	18'

8' WIDE

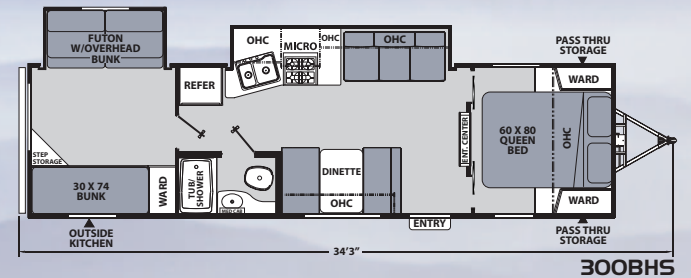
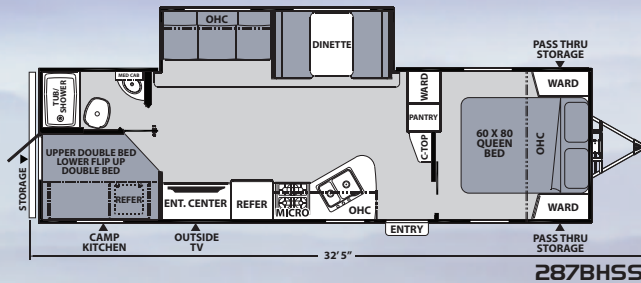
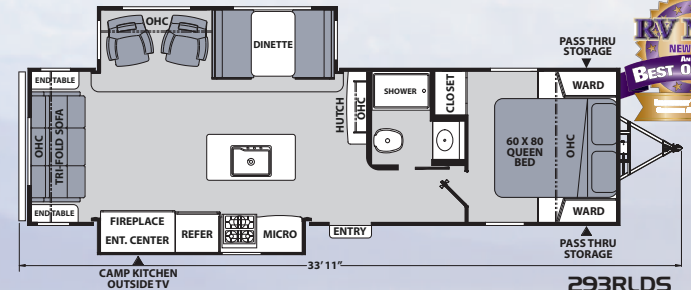
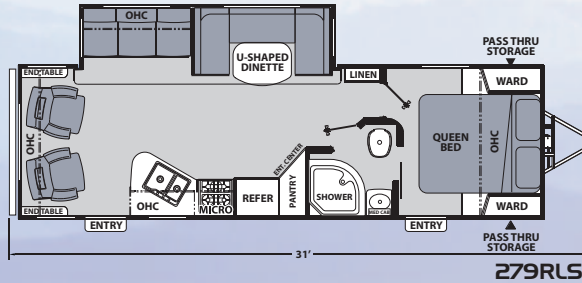
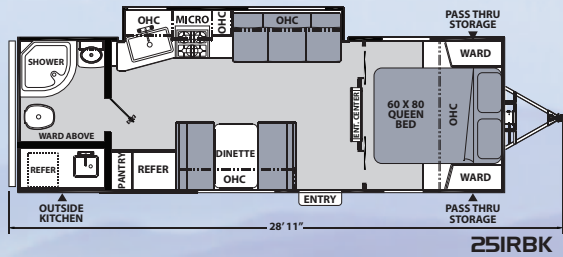
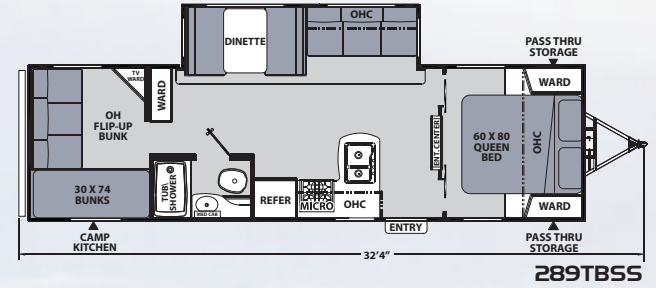
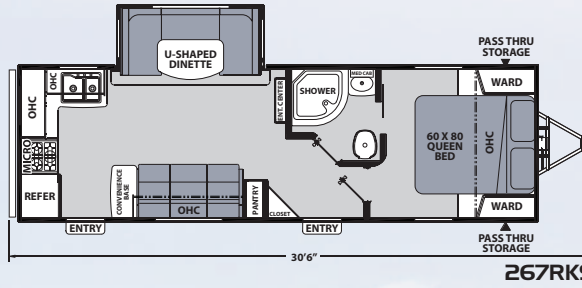
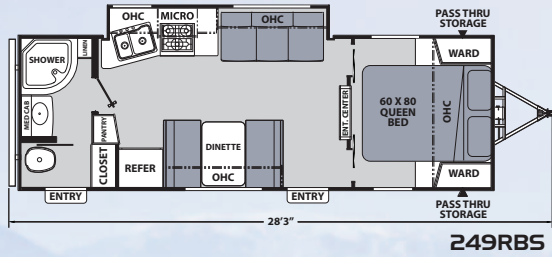
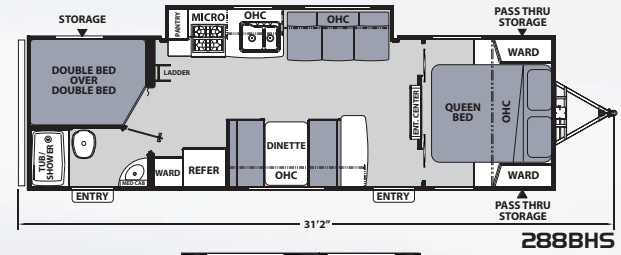
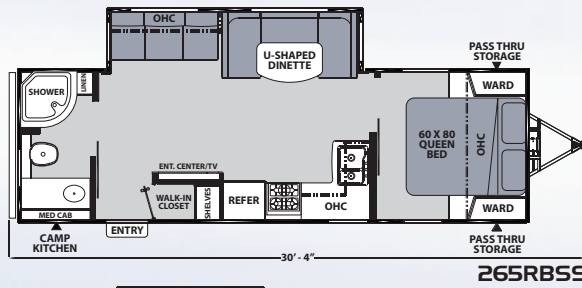
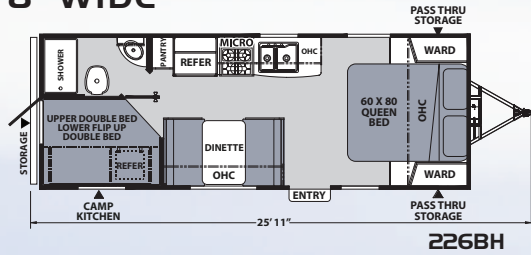

Apex 8' Wide	226BH	249RBS	251RBK	265RBSS	267RKS	279RLSS	287BHSS	288BHS	289TBSS	293RLDS	300BHS
UVW	4,436	4,770	4,984	5,652	5,415	5,490	5,946	4,882	5,720	6,440	5,977
Hitch Weight	501	480	570	734	732	620	792	585	715	832	672
Carrying Capacity	2,064	2,230	2,016	1,948	2,185	2,110	1,654	2,118	1,880	1,360	1,623
GVWR	6,500	7,000	7,000	7,600	7,600	7,600	7,600	7,000	7,600	7,800	7,600
Exterior Length (Bumper to Hitch)	25' 11"	28' 3"	28' 11"	30' 4"	30' 6"	31'	32' 5"	31' 2"	32' 4"	33' 11"	34' 3"
Exterior Height (w/A/C)	10' 3"	10' 3"	10' 3"	10' 3"	10' 3"	10' 3"	10' 3"	10' 3"	10' 3"	10' 3"	10' 3"
Fresh Water Capacity (gal.)	50	50	50	50	50	50	50	50	50	50	50
Grey Water Capacity (gal.)	35	35	35	70	70	35	35	35	35	70	35
Waste Water Capacity (gal.)	35	35	35	70	70	35	35	35	35	70	35
Awning Length	18'	16'	16'	18'	18'	18'	18'	16'	18'	18'	18'

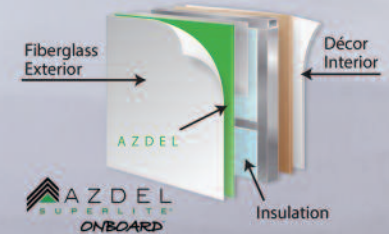

AZDEL composite panels are 50% lighter than wood, increase insulation value, and won't rot, mold or sustain water damage for years of trouble free camping.

Perfect for Smaller Tow Vehicles

Designed for towing with today's half-ton trucks, minivans and SUVs, with weights ranging from under 3,000 to 6,500 lbs.



Apex Ultra Lite Optional Features Value Package (Mandatory):

- Vacuum Bond Azdel/Fiberglass Walls
- Vacuum Bond Laminated Crowned Roof
- Laminated Floor
- Alumina-cage Construction
- Spare Tire
- Outside Speakers w/LED Lights
- Stabilizer Jacks (4)
- TV Antenna w/Cable Hook-ups
- Enclosed Underbelly w/Forced Air Heat (N/A 7.5' models)
- 13.5 BTU A/C
- Stainless Steel Microwave
- Stainless Steel Double Door Refrigerator
- Lighted Stainless Steel 3-Burner High Output Range with Oven
- AM/FM/CD/DVD Stereo w/Bluetooth
- Skylight in Bath
- Ball Bearing Drawer Guides
- Evergreen Sleep Mattress,
- Two-tone Gray Fiberglass Exterior Sidewalls,
- Dark Gray Exterior Front & Rear Walls
- LED Interior Lighting Throughout
- Power Awning w/LED lights
- LP Port
- Exterior Cable Connection
- Interior Convenience Center
- Solar Prep
- LED Motion Sensor Light in Exterior Storage Area
- Back-up Camera Mount
- Hard Valances

- Night shades
- LED TV
- Access Doors Under Dinette
- Ground Effects (Metal skirting and ABS fender skirts)
- Magnetic Door Catches
- Diamond Plate Stone Guard
- Hot/Cold Outside Shower
- Bottle Covers
- Black Tank Flush Kit
- USB Charging Station
- Swing Away Assist Handle

Summit Package:

- Fiberglass Front Cap w/LED Lighting & Front Window
- Power Tongue Jack
- High Rise Flex Pull Kitchen Faucet
- LED Accent Lighting
- Backsplash Along Kitchen Countertop
- Stonecast Sink
- Aluminum Wheels
- Flush Mount Sink Covers
- Slam Latch Baggage Doors at Pass-thru
- LED Step Light

Additional Options:

- Frameless Windows
- Hide-A-Bed Sofa (Deep Slides Only - STD on 293)
- 15K A/C Upgrade
- 50 Amp Service w/Second (Forced) 13.5K A/C
- Murphy Bed (226BH Only)

Apex Nano Optional Features Nano Package (Mandatory):

- Vacuum Bond Azdel/Fiberglass Walls
- Vacuum Bond Laminated Crowned Roof/Ceiling
- Alumina-cage Construction
- Vacuum Bond Laminated Aluminum Framed Floor
- Schwintek Slide System (N/A 15X, 185BH, 187RB)
- Outside Speakers
- Stabilizer Jacks (4)
- TV Antenna w/Cable Hook-ups
- DSI Water Heater
- Stainless Steel Microwave
- 2-Burner Cooktop
- AM/FM Stereo w/Bluetooth
- Skylight in Bath
- Evergreen Sleep Mattress
- Two-tone Grey Fiberglass Exterior Sidewall
- Dark Gray Exterior Front & Rear Walls (N/A 15X)
- LED Interior Lighting Throughout
- LP Port
- Double Door Refrigerator (N/A 15X)
- Solar Prep
- Outside Shower
- Assist Handle

Comfort Package:

- 20,000 Direct Vent Furnace
- Power Awning w/LED Lighting

Summit Package: (N/A 15X)

- Fiberglass Front Cap with Integrated Window
 - Black Tank Flush
 - Dinette Door
 - Kitchen Drawer
 - Magnetic Door Catches
- ## Additional Options:
- 13.5K A/C
 - Spare Tire & Carrier
 - Murphy Bed (203RBK, 208BHS Only)



423 N. Main Street ■ P.O. Box 30 ■ Middlebury, IN 46540
To learn more about Coachmen RV and our products and see how Coachmen is making the easy life easier, visit www.coachmenrv.com.

Your Apex Dealer



Coachmen Interactive Mobile Manuals

Download your Coachmen mobile app or visit our dynamic online manual to enhance your ownership experience. These interactive options provide incredible ease and insight into use, maintenance and enjoyment of your Coachmen product. Ranging from "How-To" videos, pictures and illustrations of various components, systems and features to fully searchable content and downloadable PDFs for individual component owner's manuals, answers are always just a click away.



Travel Easy™ Roadside Assistance

RVing is easier with Coachmen's Travel Easy™ Roadside Assistance provided FREE the first year of ownership to those who purchase a New Coachmen RV. Administered by Coach-Net, this service provides you with 24/7 operational, technical and emergency road service coverage. Also included is towing, fuel delivery, jump starts, lockout service, tire changes, mobile mechanic and unlimited technical assistance. Anywhere. Anytime. Travel Easy™ is the security of knowing that help is an easy phone call away.



www.ForestRiverBuyLocal.com



Learn More
Scan this barcode using a QR Reader on your smart phone to learn more about Forest River.



A Berkshire Hathaway company.

GVWR (Gross Vehicle Weight Rating) - is the maximum permissible weight of the unit when fully loaded. It includes all weights, inclusive of all fluids, cargo, optional equipment and accessories. For safety and product performance do NOT exceed the GVWR.

GAWR (Gross Axle Weight Rating) - is the maximum permissible weight, including cargo, fluids, optional equipment and accessories that can be safely supported by a combination of all axles.

UVW (Unloaded Vehicle Weight)* - is the typical weight of the unit as manufactured at the factory. It includes all weight at the unit's axle(s) and tongue or pin and LP Gas. The UVW does not include cargo, fresh potable water, additional optional equipment or dealer installed accessories.

*Estimated Average based on standard build optional equipment.

CCC (Cargo Carrying Capacity)** - is the amount of weight available for fresh potable water, cargo, additional optional equipment and accessories. CCC is equal to GVWR minus UVW. Available CCC should accommodate fresh potable water (8.3 lbs per gallon). Before filling the fresh water tank, empty the black and gray tanks to provide for more cargo capacity.

**Estimated average based on standard build optional equipment.

Each Forest River RV is weighed at the manufacturing facility prior to shipping. A label identifying the unloaded vehicle weight of the actual unit and the cargo carrying capacity is applied to every Forest River RV prior to leaving our facilities. The load capacity of your unit is designated by weight, not by volume, so you cannot necessarily use all available space when loading your unit.

All information contained in this brochure is believed to be accurate at the time of publication. However, during the model year, it may be necessary to make revisions and Forest River, Inc., reserves the right to make all such changes without notice, including prices, colors, materials, equipment and specifications as well as the addition of new models and the discontinuance of models shown in this brochure. Therefore, please consult with your Forest River dealer and confirm the existence of any materials, design or specifications that are material to your purchase decision. ©2018 Apex by Coachmen RV, a Division of Forest River, Inc., a Berkshire Hathaway company. All rights reserved. 10/18